

1130 Sub Arc Gun - 600 AMP



PROMASTER	LINCOLN® PART NO.	WIRE FEEDER
1130-10'		Lincoln LN7, LN8, and LN9
1130-15'	K-113	
1130-10LP		For use on Lincoln® LN25 Pro with K1500-2 receiver bushing
1130-15LP		Miller® 50, 60, and 70 series
1130M-10		
1130M-15		

*Specify wire size when ordering.

STANDARD FEATURES

- Economical replacement components including liner
- 600 amps / 60% duty cycle
- Easy field repair
- 1/16", 5/64", and 3/32" wire



Shown with Optional FH-110V and 14-297 switch housing clamp installed

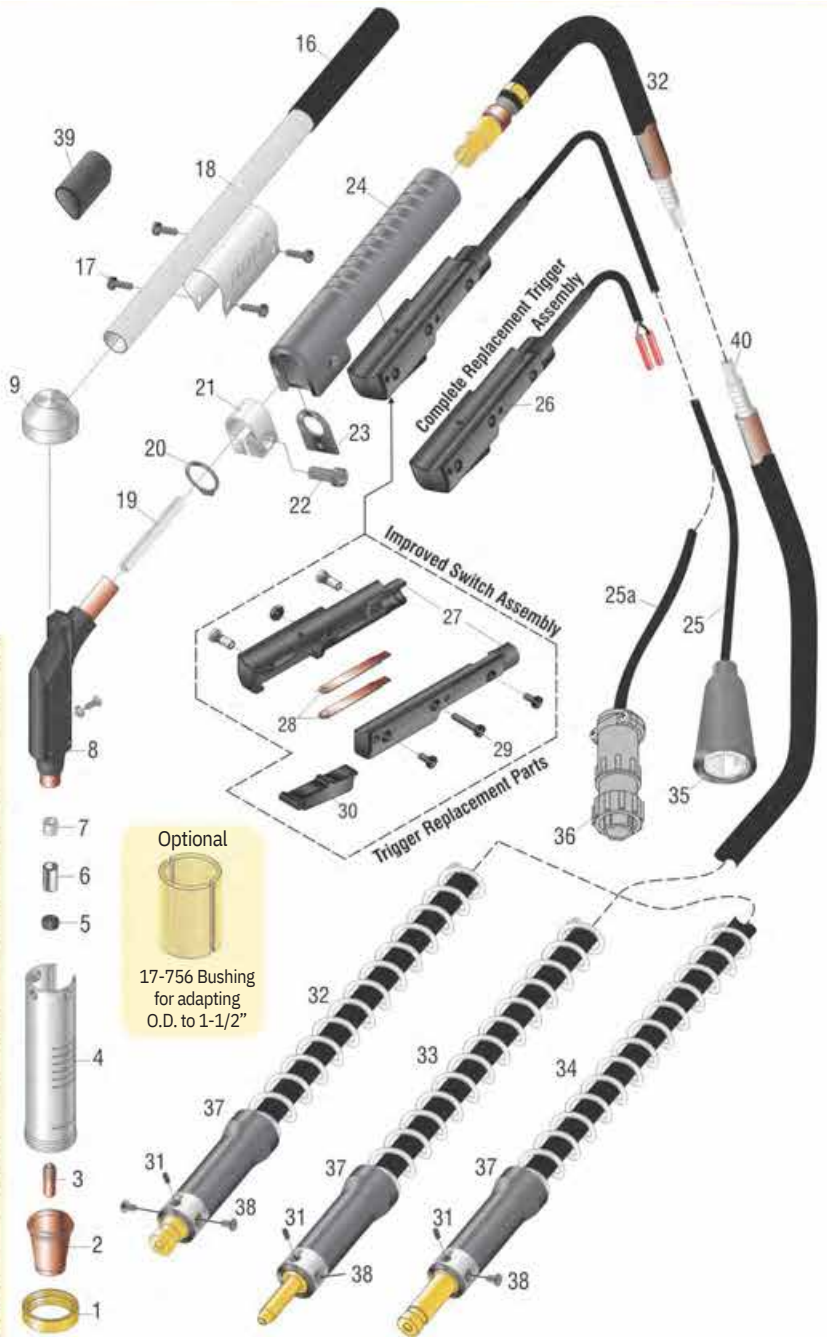

Optional

17-756 Bushing for adapting O.D. to 1-1/2"

1130
SUB ARC

NO.	PROMASTER	DESCRIPTION	NO.	PROMASTER	DESCRIPTION	NO.	PROMASTER	DESCRIPTION	I.D.	O.D.
1	17-750	Collar	15	S550HS	Replacement screws (3)	29	16-503	Screw set (6 pieces) (New Style)		
2	11-550	Nozzle flux cone 1/2"	16	17-710	Hose 15'	30	16-504	Trigger (New Style)		
	11-562	Nozzle flux cone 5/8"(std.)		17-715	Hose 21'	31	18-628	Socket head screw #8-32 x 7/16"		
	11-575	Nozzle flux cone 3/4"	17	126SS	Screw for switch housing clamp (4)	32	15-610	Conductor cable assy. 10'(Lincoln®)		
3	12-653	Contact tip 1/16"	18	17-770	Clamp and flux tube assembly		15-615	Conductor cable assy. 15'(Lincoln®)		
	12-656	Contact tip 5/64"	18a	14-297	Switch housing clamp	33	15-610M	Conductor cable assy. 10'(Miller®)		
	12-657	Contact tip 3/32"	19	13-400JL	Replacement gooseneck liner		15-615M	Conductor cable assy. 15'(Miller®)		
4	17-755	Housing	20	18-480	Retaining ring	34	15-610LP	Conductor cable assy. 10'(LN25 Pro)		
5	18-950	Liner locking screw 5/16"-18	21	14-572	Clamp		15-615LP	Conductor cable assy. 15'(LN25 Pro)		
6	18-940	Steel insert	22	14-222	Socket head cap screw	35	16-052	Trigger plug Lincoln®		
7	18-930	Ceramic insert	23	14-819	Spatter shield	36	079878	Trigger plug Miller®		
8	13-400	Gooseneck	24	14-340	Handle	37	15-531	Insulator spring w/sleeve		
9	17-760	Cap	25	16-910	New style assembly 10'(Lincoln®)	38	18-881	Flat head cap screw #8-32 x 3/8" (2)		
10	17-800	Adapter (valve head)		16-915	New style assembly 15'(Lincoln®)	39	16-321	Heat shrink		
11	S550FV	Flux valve	25a	16-910M	New style assembly 10'(Miller®)					
12	S550BHS	Screw		16-915M	New style assembly 15'(Miller®)	40	15-140	Replacement liner 10' - 1/16 - 5/64"	.156	.300
13	17-810	Adapter (flux hopper)	26	16-500	Complete trigger assy. (New Style)		15-145	Replacement liner 15' - 1/16 - 5/64"	.156	.300
14	S550H	Flux hopper w/lid & screws	27	16-501	Trigger housing (both halves)(New Style)		15-150	Replacement liner 10' - 3/32"	.180	.300
			28	16-502	Contact set (New Style)		15-160	Replacement liner 15' - 3/32"	.180	.300