

# 1140 Sub Arc Gun - 600 AMP



PROMASTER	LINCOLN® PART NO.	WIRE FEEDER
1140-10'		Lincoln® LN7, LN8, LN9
1140-15'	K114	
1140-10LP		For use on Lincoln® LN25 Pro
1140-15LP		w/K1500-2 receiver bushing
1140M-10		Miller® 50, 60, 70 series
1140M-15		

\*Specify wire size when ordering.

### STANDARD FEATURES

- Economical replacement components including liner
- 600 amps / 60% duty cycle
- Easy field repair
- 1/16", 5/64", and 3/32" wire

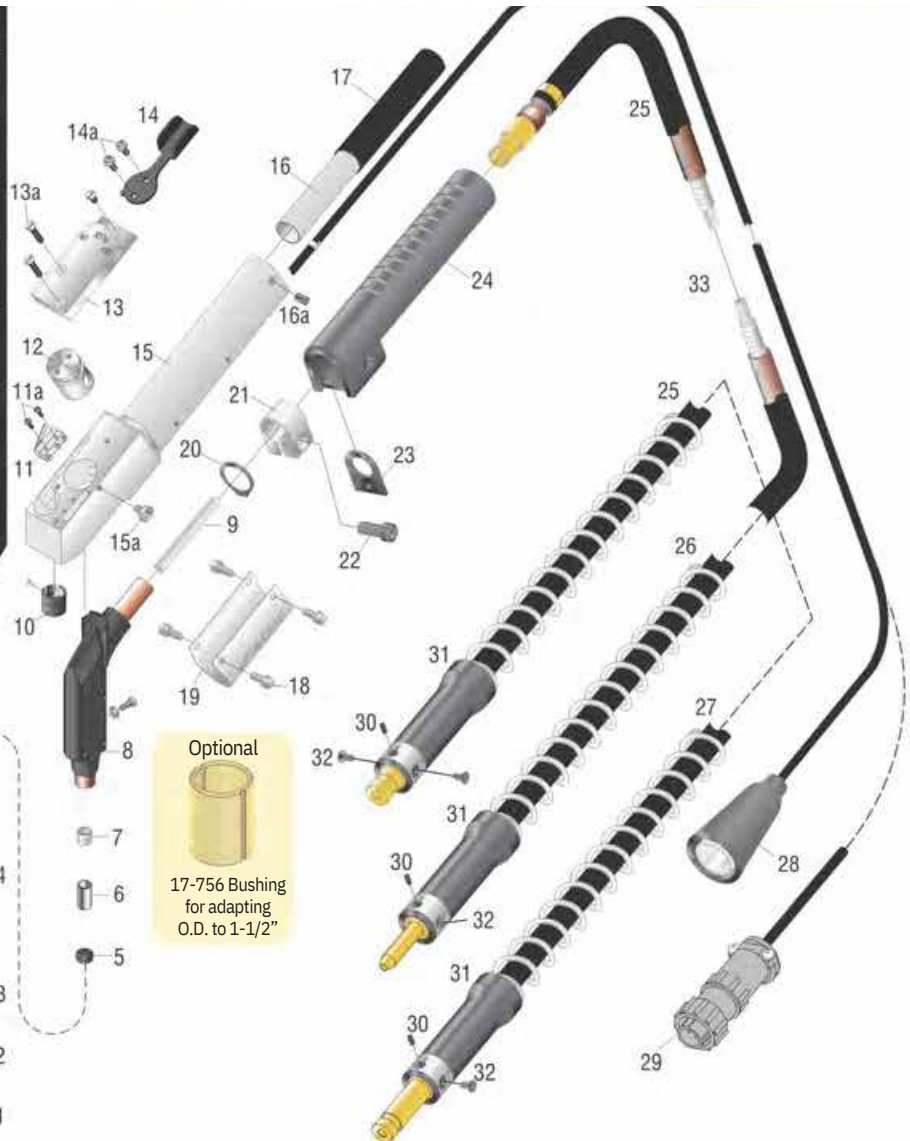

NO.	PROMASTER	DESCRIPTION	NO.	PROMASTER	DESCRIPTION
1	17-750	Collar	18	18-404	Pan head screw #8-32 x 5/16" (4)
2	11-550	Nozzle flux cone 1/2"	19	14-297	Switch housing clamp
	11-562	Nozzle flux cone 5/8(standard)	20	18-480	Retaining ring
	11-575	Nozzle flux cone 3/4"	21	14-572	Clamp
3	12-653	Contact tip 1/16"	22	14-222	Socket head cap screw
	12-656	Contact tip 5/64"	23	14-819	Spatter shield
	12-657	Contact tip 3/32"	24	14-340	Handle
4	17-755	Housing	25	15-610	Conductor cable assembly 10' (Lincoln®)
5	18-950	Liner locking screw 5/16"-18		15-615	Conductor cable assembly 15' (Lincoln®)
6	18-940	Steel insert	26	15-610M	Conductor cable assembly 10' (Miller®)
7	18-940	Ceramic insert		15-615M	Conductor cable assembly 15' (Miller®)
8	18-930	Gooseneck	27	15-610LP	Conductor cable assembly 10' (LN25 Pro)
9	13-400	Replacement gooseneck liner		15-615LP	Conductor cable assembly 15' (LN25 Pro)
10	16-301	Receptacle w/screw	28	16-610	Switch assembly 10' (Lincoln®)
11	16-752	Micro switch		16-615	Switch assembly 15' (Lincoln®)
11a	18-405	Screw 2-56 x 1/2" pan head	29	16-610M	Switch assembly 10' (Miller®)
12	17-610	Valve		16-615M	Switch assembly 15' (Miller®)
13	16-680	Cap (lever)	30	18-628	Socket head set screw #8-32 x 7/16"
13a	18-402	6-32 x 3/4" flat head screws	31	15-531	Insulator spring w/sleeve
14	16-650	Lever	32	18-881	Flat head cap screw #8-32 x 3/8" (2)
14a	18-403	6-32 x 3/8" pan head screws			Replacement liner 10' - 1/16 - 5/64
15	16-430	Housing			<b>I.D.</b> <b>O.D.</b>
15a	18-406	Screw - spring loaded	33	15-140	Replacement liner 15' - 1/16 - 5/64
16	17-765	Flux tube adapter		15-145	Replacement liner 10' - 3/32
16a	18-407	1/4"-20 x 3/16 set screw		15-150	Replacement liner 15' - 3/32
17	17-710	Hose 15'		15-160	Replacement liner 15' - 3/32
	17-715	Hose 21'			.156 .300
					.156 .300
					.180 .300
					.180 .300

SUB ARC 1140